

SALES PLAT FOR: ROCK CREEK CROSSING PLAT 4

ANKENY, IOWA

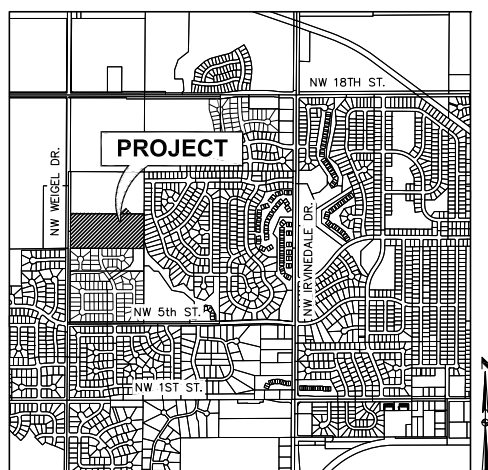

ANKENY, IOWA



PLAT INFORMATION

LOT NO.	ADDRESS	LOT PRICE	LOT WIDTH	BUILDABLE WIDTH*		FRONT SETBACK	SIDE SETBACK		REAR SETBACK	BASEMENT	M.P.E.
				RANCH	2 STORY		RANCH	2 STORY			
1	806 NW SEASONS DRIVE	SOLD	75'	60'	58'	30'	7' / 8'	8' / 9'	35'	STD	--
2	810 NW SEASONS DRIVE	SOLD	75'	60'	58'	30'	7' / 8'	8' / 9'	35'	STD	--
3	814 NW SEASONS DRIVE	SOLD	67'	52'	50'	30'	7' / 8'	8' / 9'	35'	STD	966.00'
4	904 NW SEASONS DRIVE	SOLD	75'	58'	57'	30'	7' / 8'	8' / 9'	35'	STD	966.00'
5	908 NW SEASONS DRIVE	SOLD	77'	60'	59'	30'	7' / 8'	8' / 9'	35'	STD	966.00'
6	912 NW SEASONS DRIVE 3905 NW 10TH STREET	SOLD	92'	55'	54'	30' ①	7' / 8'	8' / 9'	35'	STD	966.00'
7	915 NW RIDGELINE COURT 3909 NW 10TH STREET	SOLD	92'	55'	54'	30' ①	7' / 8'	8' / 9'	35'	DL	966.00'
8	911 NW RIDGELINE COURT	SOLD	77'	60'	59'	30'	7' / 8'	8' / 9'	35'	WO	966.00'
9	907 NW RIDGELINE COURT	SOLD	82'	69'	68'	30'	7' / 8'	8' / 9'	35'	WO	966.00'
10	903 NW RIDGELINE COURT	SOLD	48'	64'	62'	30'	7' / 8'	8' / 9'	35'	DL	--
11	902 NW RIDGELINE COURT	SOLD	48'	64'	62'	30'	7' / 8'	8' / 9'	35'	STD	--
12	906 NW RIDGELINE COURT	SOLD	46'	60'	58'	30'	7' / 8'	8' / 9'	35'	STD	--
13	910 NW RIDGELINE COURT	SOLD	77'	62'	60'	30'	7' / 8'	8' / 9'	35'**	STD	--
14	914 NW RIDGELINE COURT	SOLD	77'	56'	55'	30'	7' / 8'	8' / 9'	35'**	STD	--
15	918 NW RIDGELINE COURT 3917 NW 10TH STREET	SOLD	92'	55'	54'	30' ①	7' / 8'	8' / 9'	35'	STD	--
16	3922 NW 10TH STREET	SOLD	96'	59'	58'	30'	7' / 8'	8' / 9'	35'	WO	--
17	3918 NW 10TH STREET	SOLD	75'	60'	58'	30'	7' / 8'	8' / 9'	35'	WO	--
18	3914 NW 10TH STREET	SOLD	75'	60'	58'	30'	7' / 8'	8' / 9'	35'	DL/WO	962.50'
19	3910 NW 10TH STREET	SOLD	70'	55'	53'	30'	7' / 8'	8' / 9'	35'	DL/WO	962.50'
20	3906 NW 10TH STREET	SOLD	75'	60'	58'	30'	7' / 8'	8' / 9'	35'	STD/DL	962.50'
21	3902 NW SEASONS DRIVE 1002 NW 10TH STREET	SOLD	96'	59'	58'	30' ①	7' / 8'	8' / 9'	35'	STD	962.50'
22	1007 NW SEASONS DRIVE	SOLD	84'	68'	66'	30'	7' / 8'	8' / 9'	35'	WO	--
23	1003 NW SEASONS DRIVE	SOLD	78'	63'	61'	30'	7' / 8'	8' / 9'	35'	WO	--
24	909 NW SEASONS DRIVE	SOLD	80'	65'	63'	30'	7' / 8'	8' / 9'	35'	WO	--
25	3820 NW 9TH STREET 902 NW SEASONS DRIVE	SOLD	98'	61'	60'	30' ①	7' / 8'	8' / 9'	35'	WO	--
26	3816 NW 9TH STREET	SOLD	82'	67'	65'	30'	7' / 8'	8' / 9'	35'	WO	--
27	3812 NW 9TH STREET	SOLD	75'	60'	58'	30'	7' / 8'	8' / 9'	35'	WO	--
28	3808 NW 9TH STREET	SOLD	77'	62'	60'	30'	7' / 8'	8' / 9'	35'	WO	946.70'
29	3804 NW 9TH STREET 902 NW HORIZON DRIVE	SOLD	110'	73'	72'	30' ①	7' / 8'	8' / 9'	35'	WO	946.70'
30	906 NW HORIZON DRIVE	SOLD	88'	65'	63'	30'	7' / 8'	8' / 9'	35'	STD	946.70'
31	1004 NW HORIZON DRIVE	SOLD	101'	63'	61'	30'	7' / 8'	8' / 9'	35'	STD	--
32	1008 NW HORIZON DRIVE	SOLD	112'	68'	66'	30'	7' / 8'	8' / 9'	35'	STD	--
33	1013 NW HORIZON DRIVE	SOLD	76'	60'	58'	30'	7' / 8'	8' / 9'	35'**	WO	--
34	1009 NW HORIZON DRIVE	SOLD	70'	58'	56'	30'	7' / 8'	8' / 9'	35'	WO	--
35	1005 NW HORIZON DRIVE	SOLD	69'	52'	51'	30'	7' / 8'	8' / 9'	35'	WO	--
36	915 NW HORIZON DRIVE	SOLD	81'	65'	64'	30'	7' / 8'	8' / 9'	35'	WO	--
37	911 NW HORIZON DRIVE	SOLD	84'	72'	70'	30'	7' / 8'	8' / 9'	35'	WO	--
38	907 NW HORIZON DRIVE	SOLD	92'	72'	70'	30'	7' / 8'	8' / 9'	35'**	WO	--
39	903 NW HORIZON DRIVE	SOLD	57'	70'	69'	30'	7' / 8'	8' / 9'	35'**	WO	--
40	3807 NW 9TH STREET	SOLD	52'	70'	69'	30'	7' / 8'	8' / 9'	35'	WO	--
41	3811 NW 9TH STREET	SOLD	92'	72'	70'	30'	7' / 8'	8' / 9'	35'	STD	--
42	3813 NW 9TH STREET	SOLD	75'	60'	58'	30'	7' / 8'	8' / 9'	35'	DL	--
43	3817 NW 9TH STREET	SOLD	70'	55'	53'	30'	7' / 8'	8' / 9'	35'	DL	--
44	3821 NW 9TH STREET	SOLD	80'	65'	63'	30'	7' / 8'	8' / 9'	35'	DL/WO	--
45	3825 NW 9TH STREET	SOLD	75'	60'	58'	30'	7' / 8'	8' / 9'	35'	WO	--
46	3829 NW 9TH STREET 807 NW SEASONS DRIVE	SOLD	94'	57'	56'	30' ①	7' / 8'	8' / 9'	35'	WO	--

NOTES: ① FRONT YARD SETBACK APPLIES TO EACH STREET SIDE OF CORNER LOTS.

* BUILDABLE WIDTH IS MEASURED FROM THE FRONT YARD SETBACK. WIDTHS VARY ON SOME LOTS AND MAY BE SMALLER AS YOU PROGRESS INTO THE LOT.

** REAR YARD SETBACK VARIES DUE TO EASEMENTS

1-STORY HOMES HAVE A TOTAL SIDE YARD SETBACK OF 15'
>1-STORY HOMES HAVE A TOTAL SIDE YARD SETBACK OF 17'

STD STANDARD LOT
WO WALKOUT LOT
DL DAYLIGHT LOT
MPE MINIMUM PROTECTION ELEVATION



DIAMOND DEVELOPMENT LLC
Ankeny, Iowa

ROCK CREEK CROSSING PLAT 4

ANKENY, IOWA

