

SALES PLAT FOR: PINE VIEW ESTATES PLAT 3

ANKENY, IOWA

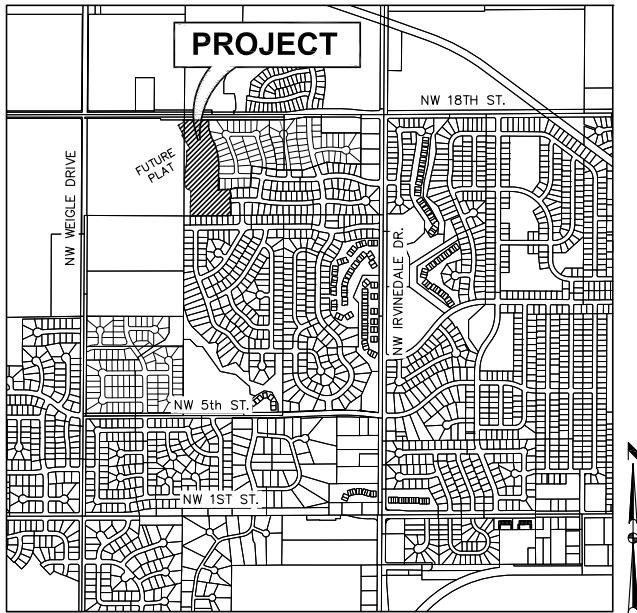

ANKENY, IOWA



PLAT INFORMATION

LOT NO.	ADDRESS	LOT PRICE	LOT WIDTH	BUILDABLE WIDTH*		FRONT SETBACK	SIDE SETBACK		REAR SETBACK	BASEMENT	M.P.E.
				RANCH	2 STORY		RANCH	2 STORY			
1	1707 NW BOULDER POINT PLACE	SOLD	118'	80'	79'	30'	7' / 8'	8' / 9'	35'	STD	--
2	1703 NW BOULDER POINT PLACE	SOLD	100'	77'	76'	30'	7' / 8'	8' / 9'	35'	STD	--
3	1615 NW BOULDER POINT PLACE	SOLD	92'	71'	69'	30'	7' / 8'	8' / 9'	35'	STD	--
4	1611 NW BOULDER POINT PLACE	SOLD	80'	65'	63'	30'	7' / 8'	8' / 9'	35'	STD	--
5	1607 NW BOULDER POINT PLACE	SOLD	75'	65'	63'	30'	7' / 8'	8' / 9'	35'	STD	958.20'
6	1603 NW BOULDER POINT PLACE	SOLD	75'	65'	63'	30'	7' / 8'	8' / 9'	35'	STD	958.20'
7	1509 NW BOULDER POINT PLACE	SOLD	79'	65'	63'	30'	7' / 8'	8' / 9'	35'	STD	958.20'
8	1505 NW BOULDER POINT PLACE 3522 NW 15TH STREET	SOLD	103'	66'	65'	30' ①	7' / 8'	8' / 9'	35'	STD	958.20'
9	3513 NW 15TH STREET	SOLD	89'	74'	72'	30'	7' / 8'	8' / 9'	35'	STD/DL	954.10'
10	1415 NW BOULDER POINT PLACE 3517 NW 15TH STREET	SOLD	115'	78'	77'	30' ①	7' / 8'	8' / 9'	35'	DL	954.10'
11	1409 NW BOULDER POINT PLACE 3524 NW 14TH STREET	SOLD	109'	72'	71'	30' ①	7' / 8'	8' / 9'	35'	STD	954.10'
12	3520 NW 14TH STREET	SOLD	80'	65'	63'	30'	7' / 8'	8' / 9'	35'	STD	954.10'
13	3516 NW 14TH STREET	SOLD	98'	75'	73'	30'	7' / 8'	8' / 9'	35'	STD	954.10'
14	3512 NW 14TH STREET	SOLD	77'	65'	63'	30'	7' / 8'	8' / 9'	35'	STD	--
15	3509 NW 14TH STREET	SOLD	82'	60'	58'	30'	7' / 8'	8' / 9'	35'	STD	--
16	3513 NW 14TH STREET	SOLD	76'	60'	58'	30'	7' / 8'	8' / 9'	35'	STD	--
17	3517 NW 14TH STREET	SOLD	75'	60'	58'	30'	7' / 8'	8' / 9'	35'	STD	--
18	3521 NW 14TH STREET	SOLD	75'	60'	58'	30'	7' / 8'	8' / 9'	35'	STD	--
19	3525 NW 14TH STREET	SOLD	75'	60'	58'	30'	7' / 8'	8' / 9'	35'	STD	--
20	3603 NW 14TH STREET	SOLD	75'	60'	58'	30'	7' / 8'	8' / 9'	35'	STD	951.70'
21	3607 NW 14TH STREET	SOLD	75'	58'	57'	30'	7' / 8'	8' / 9'	35'	STD/DL	951.70'
22	1404 NW BOULDER POINT PLACE 3602 NW 14TH STREET	SOLD	108'	71'	70'	30' ①	7' / 8'	8' / 9'	35'	STD	952.50'
23	1408 NW BOULDER POINT PLACE	SOLD	80'	66'	64'	30'	7' / 8'	8' / 9'	35'	STD	952.50'
24	1412 NW BOULDER POINT PLACE	SOLD	79'	65'	63'	30'	7' / 8'	8' / 9'	35'	DL	952.50'
25	1502 NW BOULDER POINT PLACE	SOLD	80'	65'	63'	30'	7' / 8'	8' / 9'	35'	WO	952.50'
26	1506 NW BOULDER POINT PLACE	SOLD	80'	65'	63'	30'	7' / 8'	8' / 9'	35'	WO	952.50'
27	1510 NW BOULDER POINT PLACE	SOLD	80'	65'	63'	30'	7' / 8'	8' / 9'	35'	WO	952.50'
28	1604 NW BOULDER POINT PLACE	SOLD	98'	76'	74'	30'	7' / 8'	8' / 9'	35'	WO	952.50'
29	1608 NW BOULDER POINT PLACE	SOLD	100'	78'	76'	30'	7' / 8'	8' / 9'	35'	WO	952.50'
30	1701 NW PINE VIEW CIRCLE 1612 NW BOULDER POINT PLACE	SOLD	109'	71'	70'	30' ①	7' / 8'	8' / 9'	35'	STD/DL	952.50'
31	1706 NW BOULDER POINT PLACE 1702 NW PINE VIEW CIRCLE	SOLD	96'	62'	61'	30' ①	7' / 8'	8' / 9'	35'	WO	--

NOTES: ① FRONT YARD SETBACK APPLIES TO EACH STREET SIDE OF CORNER LOTS. STD STANDARD LOT
 * BUILDABLE WIDTH IS MEASURED FROM THE FRONT YARD SETBACK. WIDTHS VARY ON SOME LOTS AND MAY BE SMALLER AS YOU PROGRESS INTO THE LOT. WO WALKOUT LOT
 DL DAYLIGHT LOT
 MPE MINIMUM PROTECTION ELEVATION

1--STORY HOMES HAVE A TOTAL SIDE YARD SETBACK OF 15'
 >1--STORY HOMES HAVE A TOTAL SIDE YARD SETBACK OF 17'

Updated 6/9/2016



DIAMOND DEVELOPMENT LLC
Ankeny, Iowa

PINE VIEW ESTATES PLAT 3

ANKENY, IOWA

